

Attachment 1 - Context Map

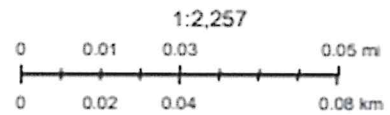

11/30/2022, 10:08:37 AM

- Override 1
- Town Limits
- █ Override 1
- Property
- █ Parks



East Community Maps Contributors, Province of Ontario, East Canada, East HERE, Garmin, SafeGraph, GeoTechnologies, Inc, METINASA, USGS, EPA, NPS, US Census Bureau, USDA, NRCAN, Parks Canada, Sources: Esri, Airbus DS, USGS, NGA, NASA, CGIAR, N Robinson, NCEAS, NLS

Web AppBuilder for ArcGIS
Town of Cobourg

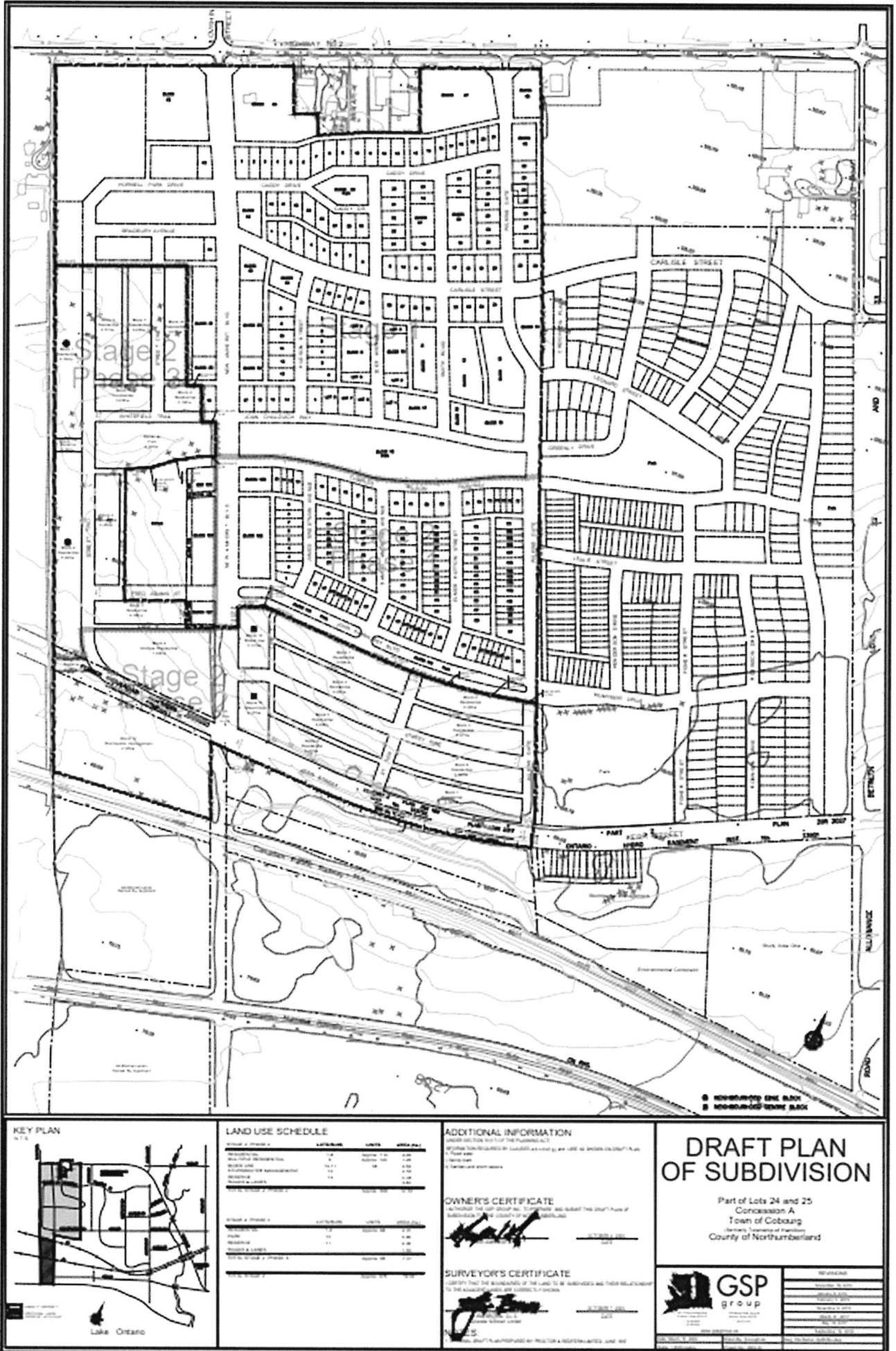

LAND USE SCHEDULE

Category	Area (sq. m)	Area (sq. ft.)	Area (acres)
Residential - Single Detached	12,345	134,567	3.08
Residential - Semi-Detached	5,678	61,234	1.40
Residential - Townhouse	3,456	37,234	0.85
Residential - Multi-Family	2,345	25,432	0.57
Commercial - Retail	1,234	13,345	0.30
Community - Park	8,901	96,123	2.19
Open Space - Greenbelt	15,678	170,234	3.87
Total	49,637	537,234	12.16

ADDITIONAL INFORMATION
 (Refer to the Schedule of Conditions and other documents attached to this plan.)

OWNER'S CERTIFICATE
 I, the undersigned, being the owner of the land to be subdivided and being duly qualified to do so, hereby certify that the information contained in this plan is true and correct.

SURVEYOR'S CERTIFICATE
 I, the undersigned, being duly qualified to do so, hereby certify that the information contained in this plan is true and correct.

DRAFT PLAN OF SUBDIVISION

Part of Lots 24 and 25
 Concession A
 Town of Cobourg
 (formerly Township of Fenelon)
 County of Northumberland

GSP group

